

Vorpa HZ - HB

Universal lighth fixing for plasterboard

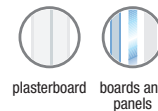

products group



HZ 29
no accessories

Suitable for

- plasterboard
- boards and panels

To fix

- skirting
- lightings, paintings
- curtains slide guides
- bath accessories
- shelves
- convectors
- motion sensors



HZV 29 TC
with cylinder head screw



HZV 29 TSP
with chipboard screw



HB 30
with countersunk head screw

product information

Characteristics

- self-tapping nylon fixing for plasterboard
- no need to pre-drill
- quick and easy installation
- suitable for wood, self-tapping and chipboard screws

Installation

- to be mounted aligned the panel

Suggestion for use

- respect the installation data
- the installation torque should be limited when using a battery operated screwdriver
- no suitable for tiled plasterboard

installation sequence

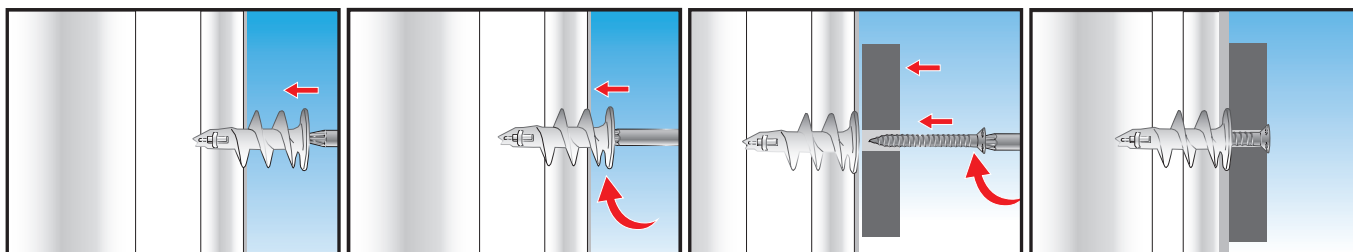

product code and technical data

Code	Description	L _t mm	T _{fix} mm	Ø _v xL _v mm
2523s	HZ 29 no accessories	29	13	4,5x25
2523	HZV 29 TC with cylinder head screw	29	13	4,5x25
2755	HZV 29 TSP with chipboard screw	29	13	4,5x25
521	HB 30 with countersunk head screw	30	12	3x25

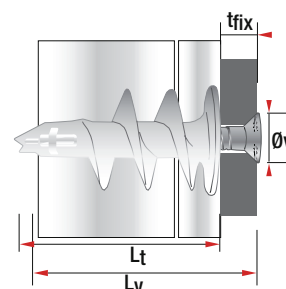

L_t = Plug length
t_{fix} = Fixture thickness
Ø_v = Screw diameter
L_v = Screw length

Screw length calculation: L_v > L_t + T_{fix}

ATTENTION: An appropriate safety factor ≥ 5 should be applied on these values

HZ - HB

	HZ	HB
Pull out values in daN		
Plasterboard 10mm	40	20
Plasterboard > 12,5 mm	50	30
Plasterboard ≥ 25 mm	67	45

1 daN ≈ 1 kg